

PULSAtron Series HV

The Pulsatron Series HV designed for high viscosity applications for precise and accurate metering control. The Series HV offers manual control over stroke length and stroke rate as standard with the option to choose between 4-20mA and external pace inputs for automatic control.

Five distinct models are available, having pressure capabilities to 150 PSIG (10 BAR) @ 12 GPD (1.9 lph), and flow capacities to 240 GPD (37.9 lph) @ 80 PSIG (5.6 BAR), with a turndown ratio of 100:1. Metering performance is reproducible to within $\pm 2\%$ of maximum capacity.

FEATURES

- Automatic Control, available with 4-20mADC direct or external pacing, with stop function.
- Manual Control by on-line adjustable stroke rate and stroke length.
- Auto-Off Manual switch.
- Highly Reliable timing circuit.
- Circuit Protection against voltage and current upsets.
- Solenoid Protection by thermal overload with auto-reset.
- Water Resistant, for outdoor and indoor applications.
- Indicator Lights, panel mounted.
- Guided Ball Check Valve Systems, to reduce back flow and enhance outstanding priming characteristics.
- Viscosities to 20,000 CPS.



BENEFITS

- Reliable metering performance.
- Rated "hot" for continuous duty.
- High viscosity capability.
- Leak-free, sealless, liquid end.



CONTROLS

Manual Stroke Rate

- Turn-Down Ratio 10:1

Manual Stroke Length

- Turn-Down Ratio 10:1

4-20mADC Direct or External Pacing with Stop

- Automatic Control



Tested and Certified by WQA
against NSF/ANSI/CAN 61 & 372.



PVDF & PVC Degass Head Pumps.
See www.wqa.org for
certification parameters.

SPECIFICATIONS

| MODEL | | LVB3 | LVF4 | LVG4 | LVG5 | LVH7 |
|-------------------------------|--------|--|------|------|------|-------|
| Capacity nominal (max.) | GPH | 0.50 | 1.00 | 2.00 | 4.00 | 10.00 |
| | GPD | 12 | 24 | 48 | 96 | 240 |
| | LPH | 1.9 | 3.8 | 7.6 | 15.1 | 37.9 |
| Pressure (max.) | PSIG | 150 | 150 | 110 | 110 | 80 |
| | BAR | 10 | 10 | 7 | 7 | 5.6 |
| Connections: | Tubing | (S) .50" I.D. X .75" O.D. .38" I.D. X .50" OD (LVB3 & F4 only) (S & D) .50" I.D. X .75" O.D. (LVG4, G5 & H7 only) | | | | |

ENGINEERING DATA

| | |
|---|--|
| Pump Head Materials Available | GFPPL, PVC |
| Diaphragm | PTFE-faced CSPE-backed |
| Check Valves Materials Available | |
| Seats/O-Rings | PTFE, CSPE, Viton |
| Balls | PTFE, 316 SS, Alloy C |
| Fittings Materials Available | GFPPL, PVC |
| Injection Valve & Foot Valve Assy | Same as fitting and check valve selected |
| Tubing | Clear PVC, White PE |

Important: Material Code - GFPPL=Glass-filled Polypropylene, PVC=Polyvinyl Chloride, PE=Polyethylene, PVDF=Polyvinylidene Fluoride, CSPE=Generic formulation of Hypalon, a registered trademark of E.I. DuPont Company. Viton is a registered trademark of E.I. DuPont Company. PVC wetted end recommended for sodium hypochlorite.

| | |
|----------------------------------|--|
| Reproducibility | ±2% at maximum capacity |
| Viscosity Max CPS | 20,000 CPS |
| Stroke Frequency Max SPM | 125 |
| Stroke Frequency Turn-Down Ratio | 10:1 |
| Stroke Length Turn-Down Ratio | 10:1 |
| Power Input | 115 VAC / 50-60 HZ / 1 ph 230 VAC / 50-60 HZ / 1 ph |
| Average Current Draw | |
| @ 115 VAC: Amps | 1.0 Amps |
| @230 VAC: Amps | 0.5 Amps |
| Peak Input Power | 300 Watts |
| Average Input Power @ Max SPM | 130 Watts |
| Approvals | Conforms to ANSI/NSF STD. 50 |

DIMENSIONS

| Series HV Dimensions (inches) | | | | | |
|-------------------------------|-----|------|------|-----|-----------------|
| Model No. | A | B | C | D | Shipping Weight |
| LVB3 | 5.4 | 9.3 | 9.5 | 7.5 | 13 |
| LVF4 | 5.4 | 10.8 | 10.8 | 7.5 | 18 |
| LVG4 | 5.4 | 9.5 | 10.6 | 7.5 | 18 |
| LVG5 | 5.4 | 10.8 | 10.8 | 7.5 | 18 |
| LVH7 | 6.1 | 11.5 | 11 | 8.2 | 25 |

NOTE: Inches X 2.54 = cm

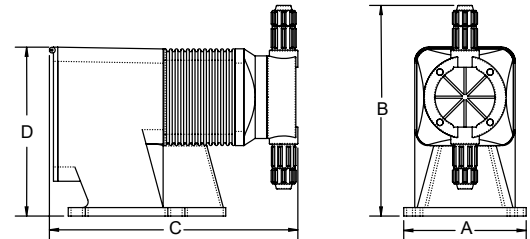

27101 Airport Road
Punta Gorda, FL 33982
Tel: (941) 575-3800
Fax: (941) 575-4085
www.pulsatron.com



An ISO Certified Company

