

# PULSAFEEDER®

The Pulsafeeder diaphragm Back Pressure Valves are designed to enhance the performance of chemical feed systems by applying a continuous back pressure to the chemical feed pump, while also acting as an anti-siphon valve. Robust construction ensures reliability in the rigorous service of municipal and industrial applications. Wetted materials include: PVC, PVDF, PTFE, 316SS. Available sizes: 1/2" – 1.5".

Pulsafeeder diaphragm Back Pressure Valves apply positive discharge pressure to the chemical metering pump system to prevent siphoning and eliminate varying dosage rates caused by fluctuating downstream pressure. The diaphragm is held against the valve seat by an internal spring.

When the preset pressure is exceeded the diaphragm is forced up and the chemical flows through the valve to the injection point. The valves are pre-set at 50 psi, however they are field adjustable from 10 -150 psi, via the adjustment screw. The relief valve should be installed as close to the injection point as possible to prevent chemical line drainage and it is most important that all chemical system equipment such as pulsation dampeners and pressure gauges are between the pump and back pressure valve.

## Features

- Highly Reliable
- Adjustable Pressure Settings
- Low Cost
- Compact Size.
- Robust, Machined Construction.
- Wide Range of Materials.

## Operating Benefits

- Adjustable 10-150 psi
- 10-250 psi Stainless only
- Vulcanized PTFE/EPDM Diaphragm
- Anti-siphon function.

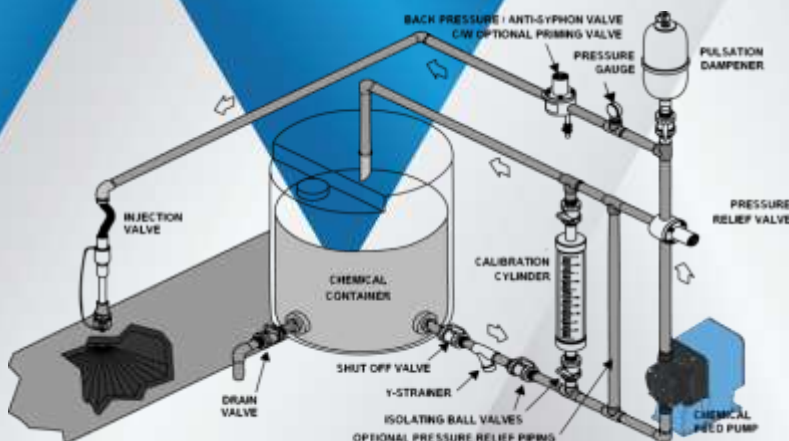

## Aftermarket

- Double Wall Containment Tanks from 15 to 500 gallons.
- 1, 2, or 4 Drum Spill Containment Pallets.
- Loading Ramp and Pallet with or without Cover.



## Back Pressure Valve

# Back Pressure Valve

## Specifications and Model Selection

Back Pressure Valves	1/2"	PVC/TFE	NA200001-PVC
	1/2"	PVDF/TFE	NA200001-PVD
	1/2"	SS/TFE	NA200001-316
	1"	PVC/TFE	NA200002-PVC
	1"	PVDF/TFE	NA200002-PVD
	1"	SS/TFE	NA200002-316
	1.5"	PVC/TFE	NA200003-PVC
	1.5"	PVDF/TFE	NA200003-PVD

## Engineering Data

<b>Size:</b>	1/2"	
	1.0"	
	1.5"	
<b>Connections:</b>	NPT	
<b>Pressure Relief Adjustment:</b>	10-150 psi	
	10-250 psi Stainless	
<b>Max Temperature:</b>	PVC:	140°F
	PVDF:	280°F
	Metal:	300°F
<b>Max. Operating Pressure @ 70°F: (psi)</b>	Plastic/Noryl:	375 psi
	Metal/Metal:	2000 psi
<b>Materials Of Construction:</b>	PTFE/EPDM	
<b>Diaphragm:</b>	Noryl (Threaded to Plastic Valves, Bolted to Metal Valves)	
<b>Valve Top:</b>	Optional: 316SS.	
<b>Valve Body:</b>	PVC	
	PVDF	
	316 SS	
<b>Flow Rate @ 150 psi Pulsating:</b>	1/2" -	100 USgph
	1" -	500 USgph
	1 1/2" -	1200 USgph
<b>Continuous:</b>	1/2" -	15 USgpm
	1" -	26 USgpm
	1 1/2" -	63 USgpm

## Performance Curves

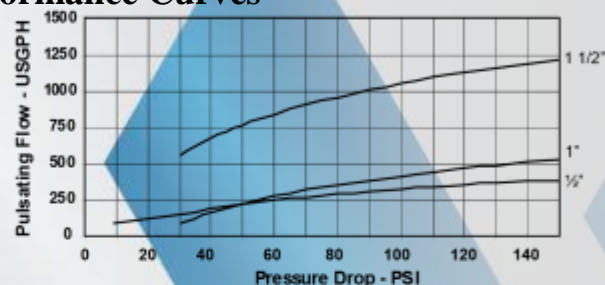

## Custom Engineered Designs – Pre-Engineered Systems



### Pre-Engineered Systems

Pulsafeeder's Pre-Engineered Systems are designed to provide complete chemical feed solutions for all electronic metering applications. From stand alone simplex pH control applications to full-featured, redundant sodium hypochlorite disinfection metering, these rugged fabricated assemblies offer turn-key simplicity and industrial-grade durability. The UV-stabilized, high-grade HDPE frame offers maximum chemical compatibility and structural rigidity. Each system is factory assembled and hydrostatically tested prior to shipment.

## Dimensions

Size	A	B	C
1/2"	4.25	2.35	1.08
1"	5.86	3.5	1.25
1 1/2"	8.35	4.9	1.825

Note: 1 1/2" valves do not have bottom port

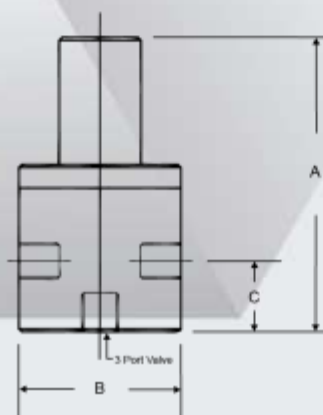

27101 Airport Road  
Punta Gorda, FL 33982  
Phone: ++1(941) 575-3800  
Fax: ++1(941) 575-4085

www.pulsatron.com



An ISO 9001 Certified Company

BPV001 J14

